

SCALE : 1 : 18 000

SCALE : 1 : 3 000

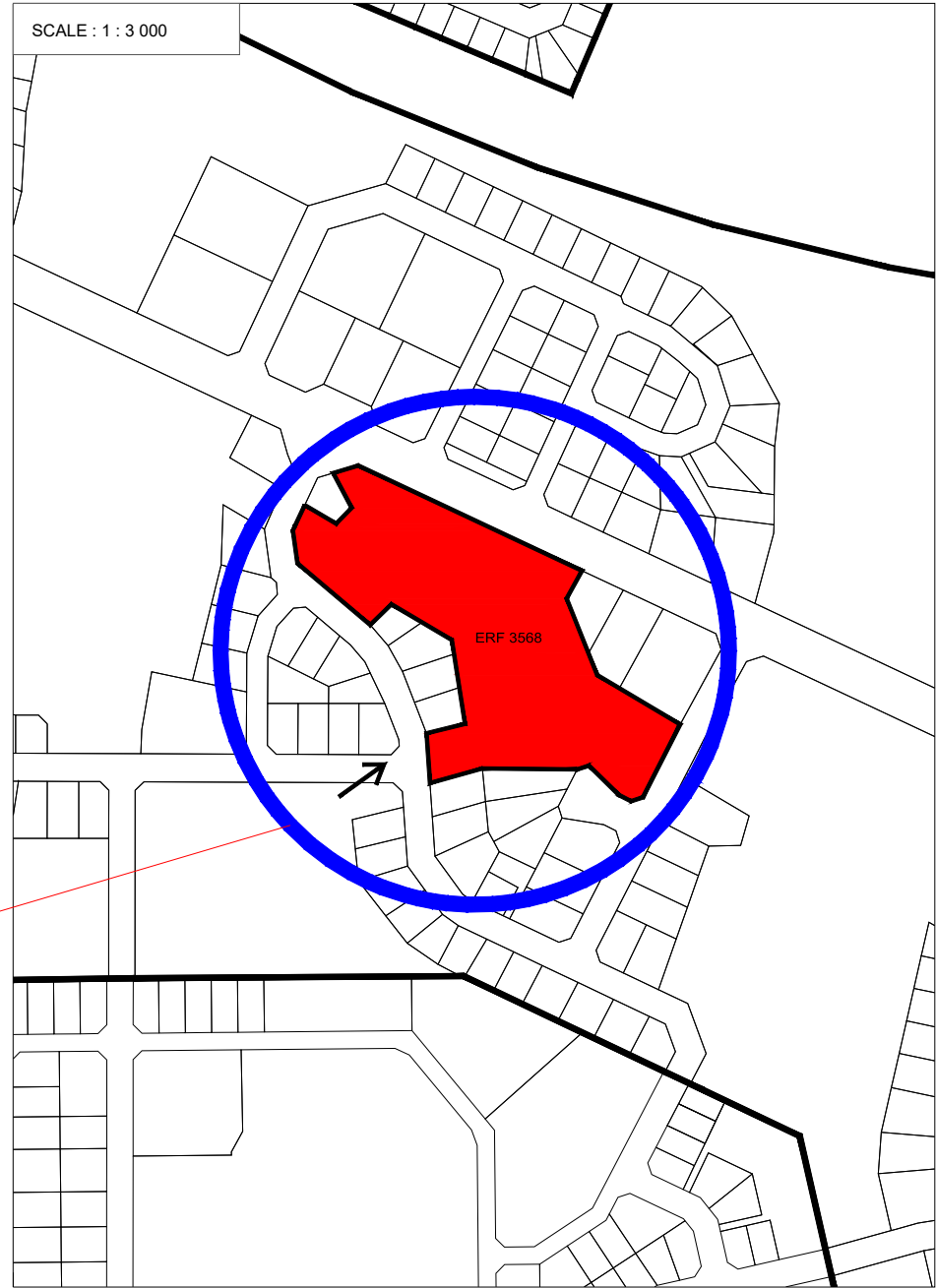
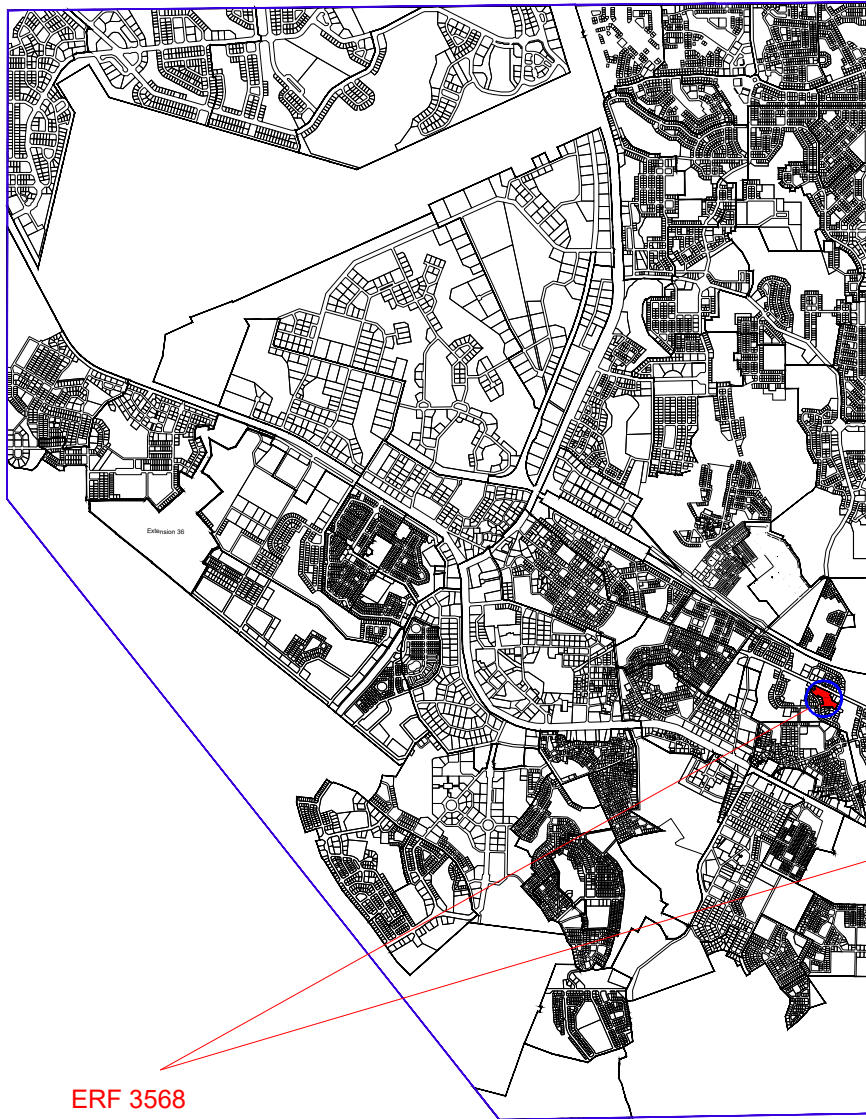

LOCALITY OF ERF 3568, ONDANGWA EXTENSION 16

SCALE : 1 : 18 000 (INSERT - 1 : 3 000)

DATE: JANUARY 2026

GEOGRAPHIC COORDINATES	
LATITUDE	-17.911298°
LONGITUDE	15.995381°



CONSULTANT	NPC
DRAWN BY	NNK
CLIENT	MR AMUTENYA
DRAWING NO	OND 01-11-2025



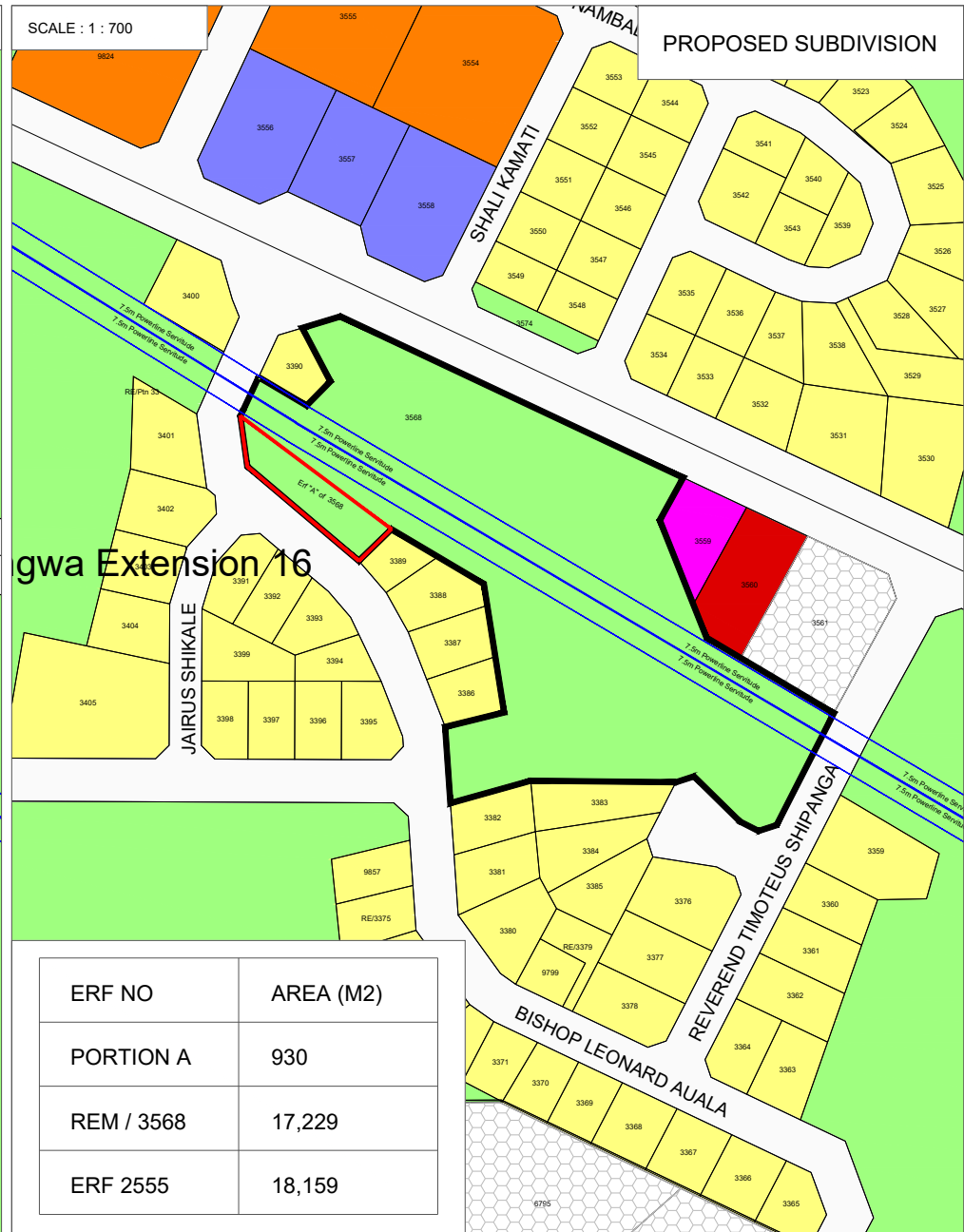
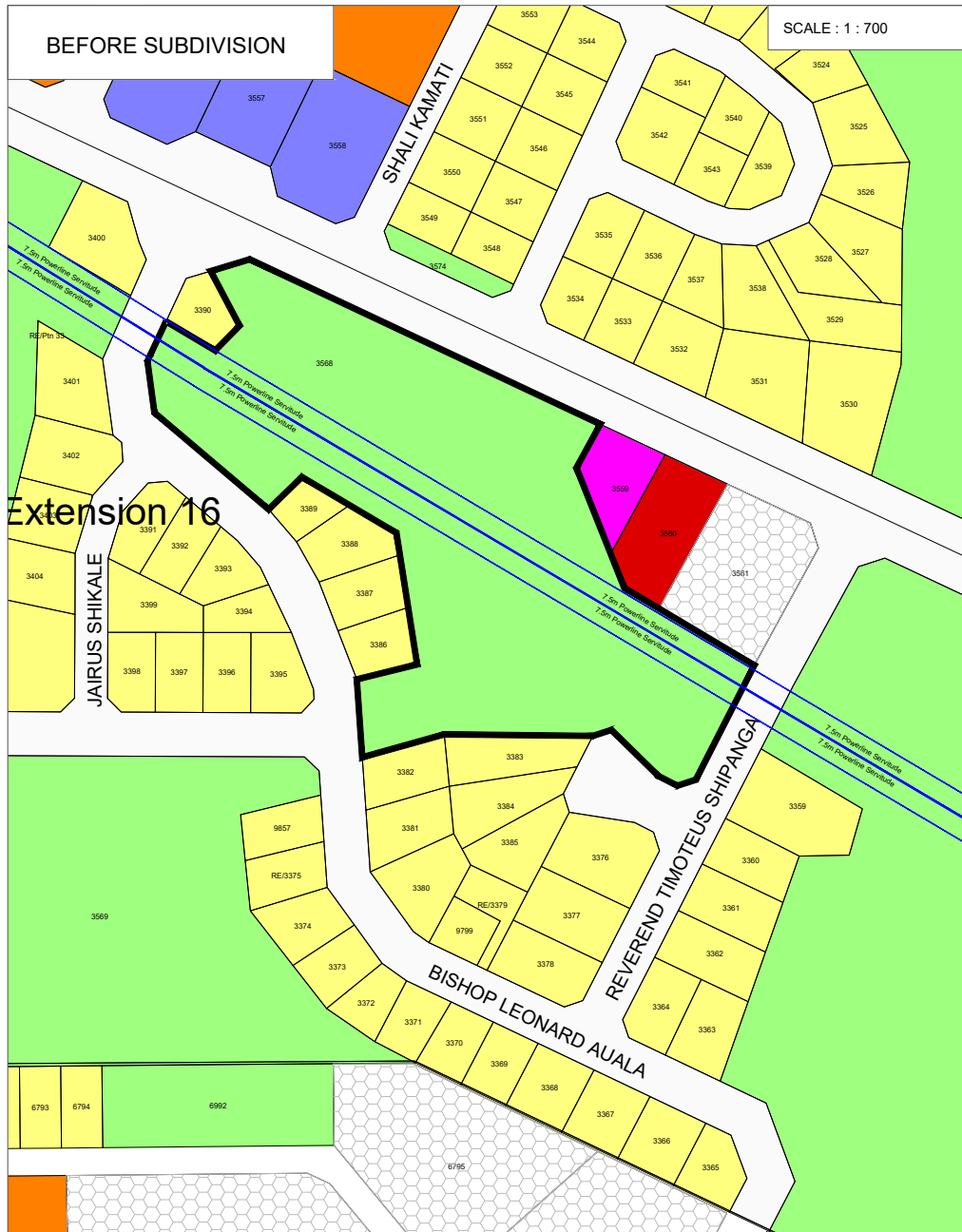

ERF NO	AREA (M2)
PORTION A	930
REM / 3568	17,229
ERF 2555	18,159

SUBDIVISION OF ERF 3568 (POS), ONDANGWA EXTENSION 16 INTO PORTION A AND REMAINDER

SCALE : 1:700

DATE: JANUARY 2025

LEGEND	
	SUBDIVISION BOUNDARY
	ERF 3568 BOUNDARY
	CONTOURS



CONSULTANT	NPC
DRAWN BY	NNK
CLIENT	MR AMUTENYA
DRAWING NO	OND-02-11-2025



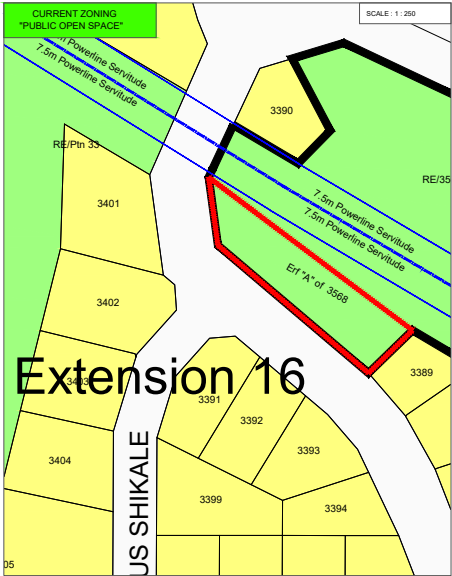

Extension 16

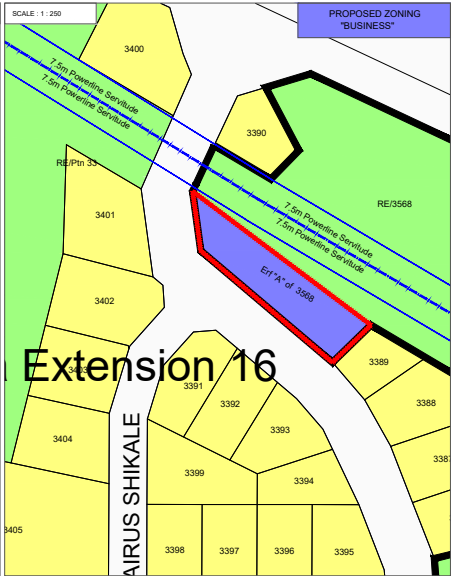

Extension 16

REZONING OF PORTION A OF ERF 3568, ONDANGWA EXTENSION 16 FROM "PUBLIC OPEN SPACE" TO "BUSINESS"

LEGEND	
	PUBLIC OPEN SPACE
	INSTITUTIONAL
	PORTION A BOUNDARIES



PLANNING SERVICES

CONSULTANT	NPC
DESIGNED BY	NAME
CLIENT	MR ABUUTENYA
DRAWING NO	2ND-04-11-2025



SCALE: 1:250

DATE: JANUARY 2025